

Room Data Sheet

PHYSICS TEACHING LAB

Department: PHYSICS

Area /Occupancy		Fire Protection		Electrical	
Target Area :	1300	FP System:	Yes	Power:	Standard / Coord. w/ equipment
Actual Area :	1,213 SF	FP Detection:	Yes	Features:	
Occupants :	24			Elec. Outlets:	Perimeter, Floor, Ceiling
Quantity :	3			Fixtures:	LED
Architectural		Plumbing		Electrical	
Floor:	Linoleum / Rubber	Sinks:	Phenolic Resin	Fixt. Mounting:	Pendant
Base:	Rubber	Pure Water:	No	Occ. Sensors:	Yes
Walls:	Existing CMU / Gypsum	Hot/Cold Water:	Yes	Dim Switch:	Yes
Wall Finish:	Paint - low v.o.c	Floor Drain:	At emergency shower	Task Light:	No
Ceiling:	OTS	Waste:	No	Emerg. Power:	Yes
Ceiling Height:		Emer. Eyewash:	Yes	UPS:	Yes
Door Size:	3'-6" single leaf	Emer. Station:	Yes		
Casework		Gases:		Communications	
Wall Cabinets:	Wood	Comp. Air:	No	# Phone Outlets:	NA
Base Cabinets:	Wood	Lab Gas:	No	# Data Outlets:	(1) Floor, (3) Wall
Counter Tops:	Phenolic Resin	Vacuum:	No	Network:	Wireless
Counter Height:	Varies: 34" / 36"	CO ² :		Clocks:	No
Shelving:	Yes, as noted	Nitrogen:		Paging System:	No
Drawer Units:	No	Oxygen:		Monitor/Alarm:	No
		Other Gas:		Other:	
Furnishings		HVAC		Special Requirements	
Window Treat:	No	Air Changes:	Min (Occ/Unocc):Vent/0	Lighting Controls:	
Proj. Screen:	Yes	Air Circulation:		Visual Controls:	
Desks:	No	Pressure:		Acoustic Req:	
Chairs:	Moveable	Temperature:	(Clg/Htg):75F/70F	STC Rating:	
Tables:	Moveable			Structural Req:	
Files:	No	Rel. Humidity:	(Sum/Win): 55%/35%	Security:	Card Access
White Boards:	Yes, Sliding	Local Exhaust:		Shielding:	No
Tack Boards:	No	Air Filtration:		Other Spec Req:	
Other Furn:	Instructors Bench	O2 Sensor:			
		Other HVAC:			
Notes					
Ceiling Mounted LCDs , Ceiling mounted power & data reels					

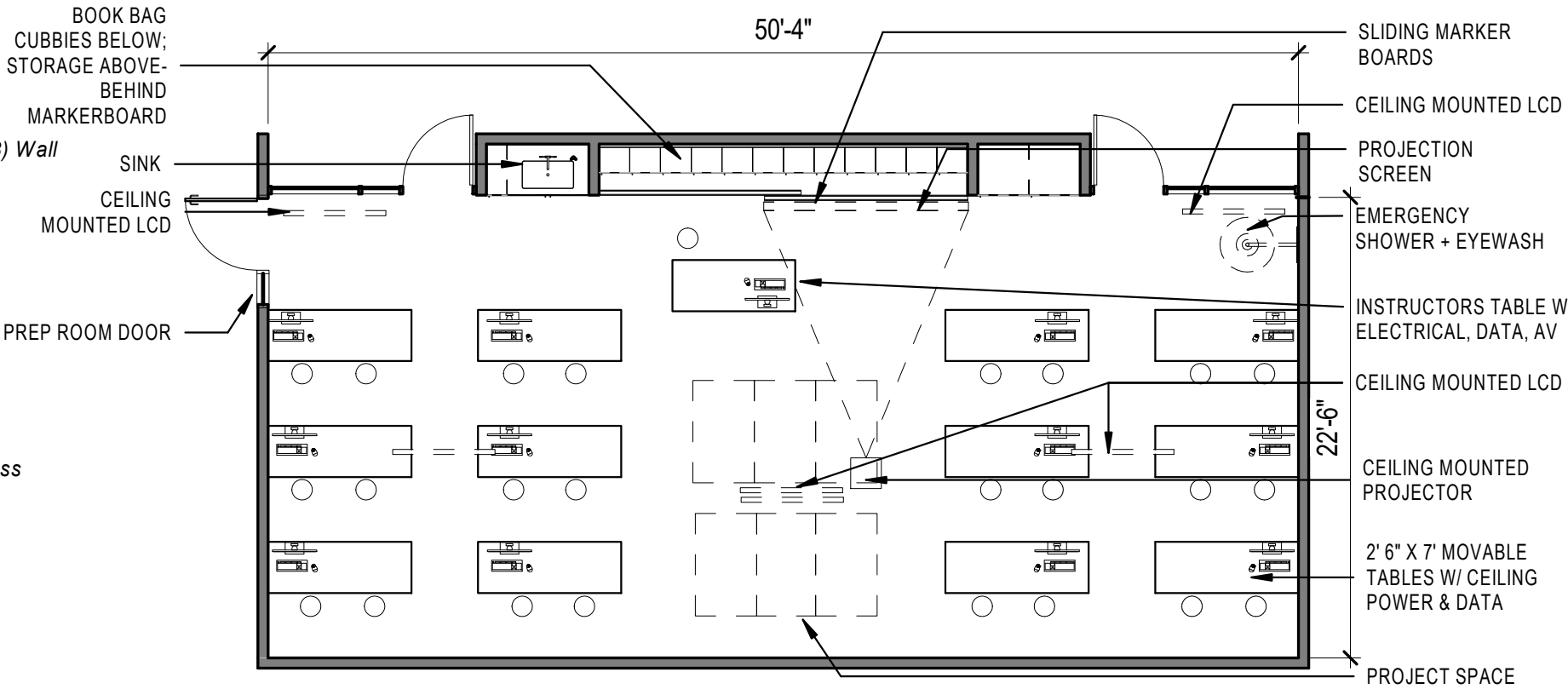

SCALE: 1/8" = 1'-0"



Room Data Sheet

PHYSICS PREP / STORAGE

Department: PHYSICS

Area /Occupancy		Fire Protection	Electrical
Target Area :	600	FP System: Yes	Power: Standard / Coord. w / equipment
Actual Area :	406 SF	FP Detection: Yes	Features:
Occupants :			Elec. Outlets: Perimeter
Quantity :	1		Fixtures: LED
Architectural		Plumbing	Fixt. Mounting: Pendant
Floor:	Linoleum	Sinks: Phenolic Resin	Occ. Sensors: Yes
Base:	Rubber	Pure Water: No	Dim Switch: No
Walls:	Existing CMU / Gypsum	Hot/Cold Water: Yes	Task Light: No
Wall Finish:	Paint - low V.O.C.	Floor Drain: No	Emerg. Power: No
Ceiling:	OTS	Waste: No	UPS: No
Ceiling Height:		Emer. Eyewash: No	
Door Size:	3'-6" single leaf	Emer. Station: No	
Casework		Gases:	Communications
Wall Cabinets:	Wood	Comp. Air: No	# Phone Outlets: NA
Base Cabinets:	Wood	Lab Gas: No	# Data Outlets: 2
Counter Tops:	Phenolic Resin	Vacuum: No	Network: Wireless
Counter Height:	Varies: 36" / 34"	CO ² :	Clocks: No
Shelving:	Yes, as noted	Nitrogen:	Paging System: No
Drawer Units:	Yes	Oxygen:	Monitor/Alarm: No
		Other Gas:	Other:
Furnishings		HVAC	Special Requirements
Window Treat:	No	Air Changes: Min (Occ/ Unocc):Vent/0	Lighting Controls:
Proj. Screen:	No	Air Circulation:	Visual Controls:
Desks:	No	Pressure:	Acoustic Req:
Chairs:	Moveable	Temperature: (Clg/Htg):75F/70F	STC Rating:
Tables:	No		Structural Req:
Files:	No	Rel. Humidity: Sum/Win):55%/35%	Security: Card Access
White Boards:	Yes	Local Exhaust:	Shielding: No
Tack Boards:	No	Air Filtration:	Other Spec Req:
Other Furn:		O2 Sensor:	
		Other HVAC:	

Notes

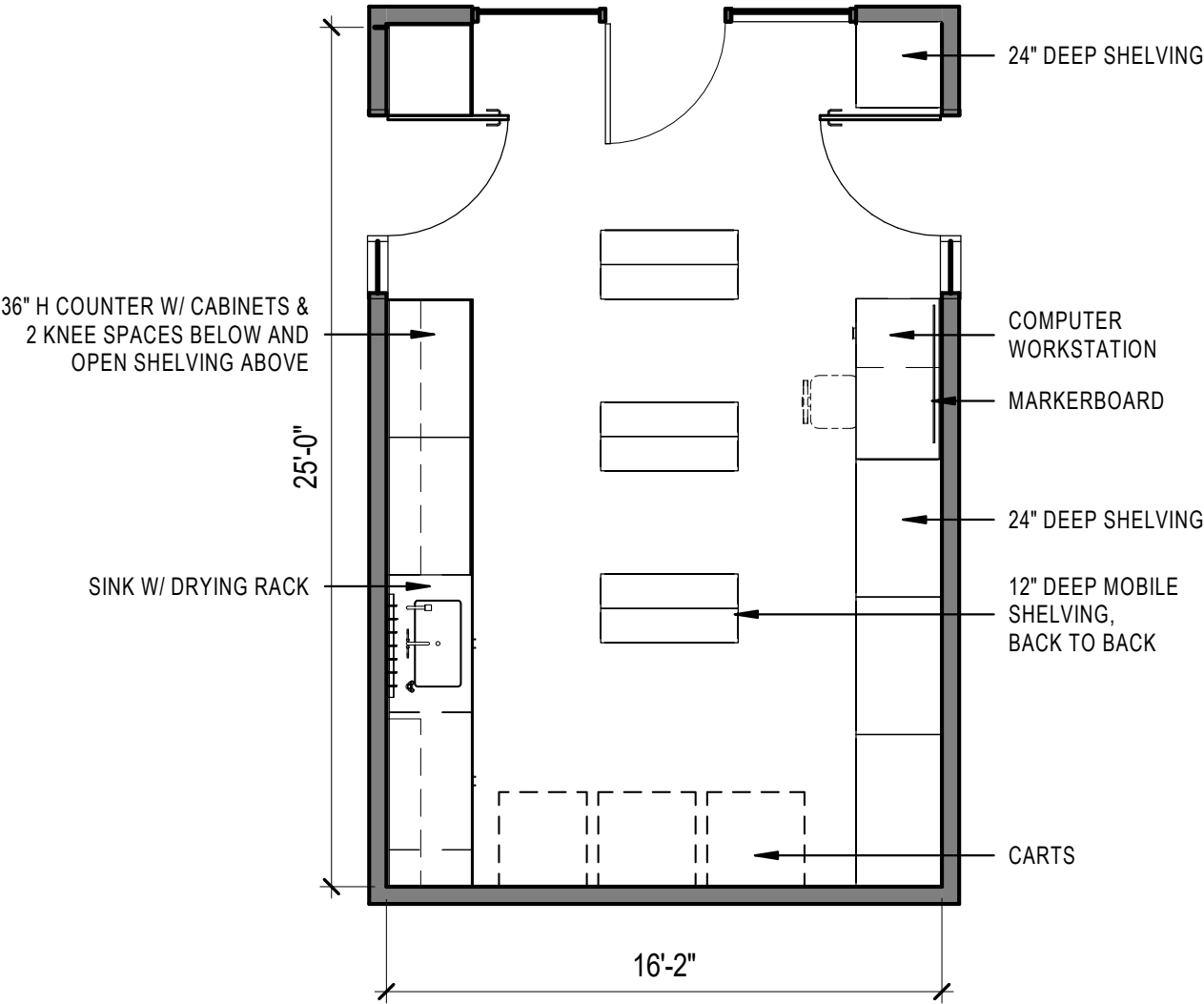

Room Data Sheet

CLASSROOM - 100 PERSON

Department: CLASSROOM - LECTURE

Appendix B3

Area /Occupancy		Fire Protection		Electrical	
Target Area :	2500	FP System:	Yes	Power:	Standard
Actual Area :	2,179 SF	FP Detection:	Yes	Features:	
Occupants :	99			Elec. Outlets:	Perimeter, Floor
Quantity :	1			Fixtures:	LED
				Fixt. Mounting:	Pendant
				Occ. Sensors:	Yes
				Dim Switch:	Yes
				Task Light:	No
				Emerg. Power:	Yes
				UPS:	Yes
Architectural		Plumbing		Communications	
Floor:	Carpet Tile	Sinks:	No	# Phone Outlets:	No
Base:	Wood	Pure Water:	NA	# Data Outlets:	(1) Floor, (3) Wall
Walls:	Existing CMU / Gypsum	Hot/Cold Water:	NA	Network:	Wireless
Wall Finish:	Paint - low v.o.c	Floor Drain:	No	Clocks:	No
Ceiling:	Acoustic Baffles	Waste:	No	Paging System:	No
Ceiling Height:	11'-0"	Emer. Eyewash:	No	Monitor/Alarm:	No
Door Size:	3'-6" single leaf	Emer. Station:	No	Other:	
		Gases:			
		Comp. Air:	No		
		Lab Gas:	No		
		Vacuum:	No		
		CO²:			
		Nitrogen:			
		Oxygen:			
		Other Gas:			
Casework		HVAC		Special Requirements	
Wall Cabinets:	No	Air Changes:	Min (Occ/Unocc):Vent/0	Lighting Controls:	
Base Cabinets:	No	Air Circulation:		Visual Controls:	
Counter Tops:	No	Pressure:		Acoustic Req:	
Counter Height:	No	Temperature:	(Clg/Htg):73F/72F	STC Rating:	
Shelving:	No			Structural Req:	
Drawer Units:	No			Security:	
				Shielding:	No
				Other Spec Req:	
Furnishings					
Window Treat:					
Proj. Screen:	Yes				
Desks:					
Chairs:	Moveable				
Tables:	Moveable				
Files:					
White Boards:	80% perimeter of room				
Tack Boards:					
Other Furn:	Instructors Table				
Notes					

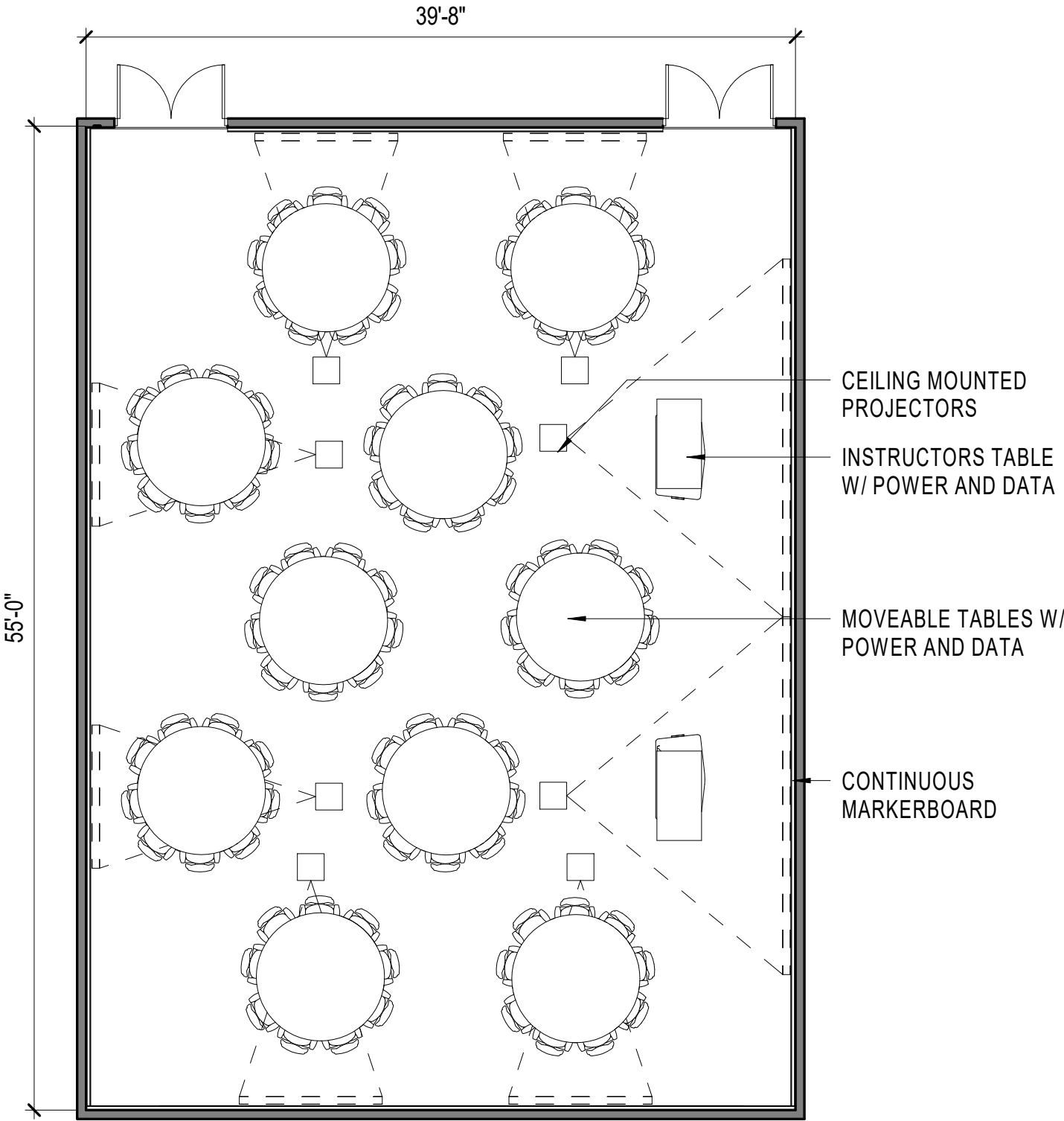

SCALE: 1/8" = 1'-0"



Room Data Sheet

GENERAL CLASSROOM - 54 STUDENT

Department: GENERAL

Area /Occupancy		Fire Protection	Electrical
Target Area :	1,200 SF	FP System: Yes	Power: Standard
Actual Area :	1,170 SF	FP Detection: Yes	Features:
Occupants :	54 Max - See Notes		Elec. Outlets: Perimeter, Floor
Quantity :	4		Fixtures: LED
Architectural		Plumbing	Fixt. Mounting: Pendant
Floor:	Carpet Tile	Sinks: No	Occ. Sensors: Yes
Base:	Rubber	Pure Water: NA	Dim Switch: Yes
Walls:	Existing CMU / Gypsum	Hot/Cold Water: NA	Task Light: No
Wall Finish:	Paint, low V.O.C.	Floor Drain: No	Emerg. Power: Yes
Ceiling:	OTS	Waste: NA	UPS: Yes
Ceiling Height:		Emer. Eyewash: No	
Door Size:	36" single leaf	Emer. Station: No	Communications
Casework		Gases:	# Phone Outlets: No
Wall Cabinets:	NA	Comp. Air: No	# Data Outlets: (1) Floor, (3) wall
Base Cabinets:	NA	Lab Gas: No	Network: Wireless
Counter Tops:	NA	Vacuum: No	Clocks: No
Counter Height:	NA	CO²:	Paging System: No
Shelving:	NA	Nitrogen:	Monitor/Alarm: No
Drawer Units:	NA	Oxygen:	Other:
Furnishings		Other Gas:	Special Requirements
Window Treat:	Light Filtering	HVAC	Lighting Controls:
Proj. Screen:	Yes	Air Changes: Min (Occ/Unocc):Vent/0	Visual Controls:
Desks:	NA	Air Circulation:	Acoustic Req:
Chairs:	Mobile	Pressure:	STC Rating:
Tables:	Yes, mobile, systems	Temperature: (Clg/Htg):73F/72F	Structural Req:
Files:	NA	Rel. Humidity: (Sum/Win): 55%/35%	Security:
White Boards:	Yes	Local Exhaust:	Shielding: No
Tack Boards:	No	Air Filtration:	Other Spec Req:
Other Furn:	Instructors Lectern	O2 Sensor:	
Notes		Other HVAC:	
Seating arrangement with Node chairs allows for maximum 54 student capacity. Table arrangement provides 48 student maximum capacity			

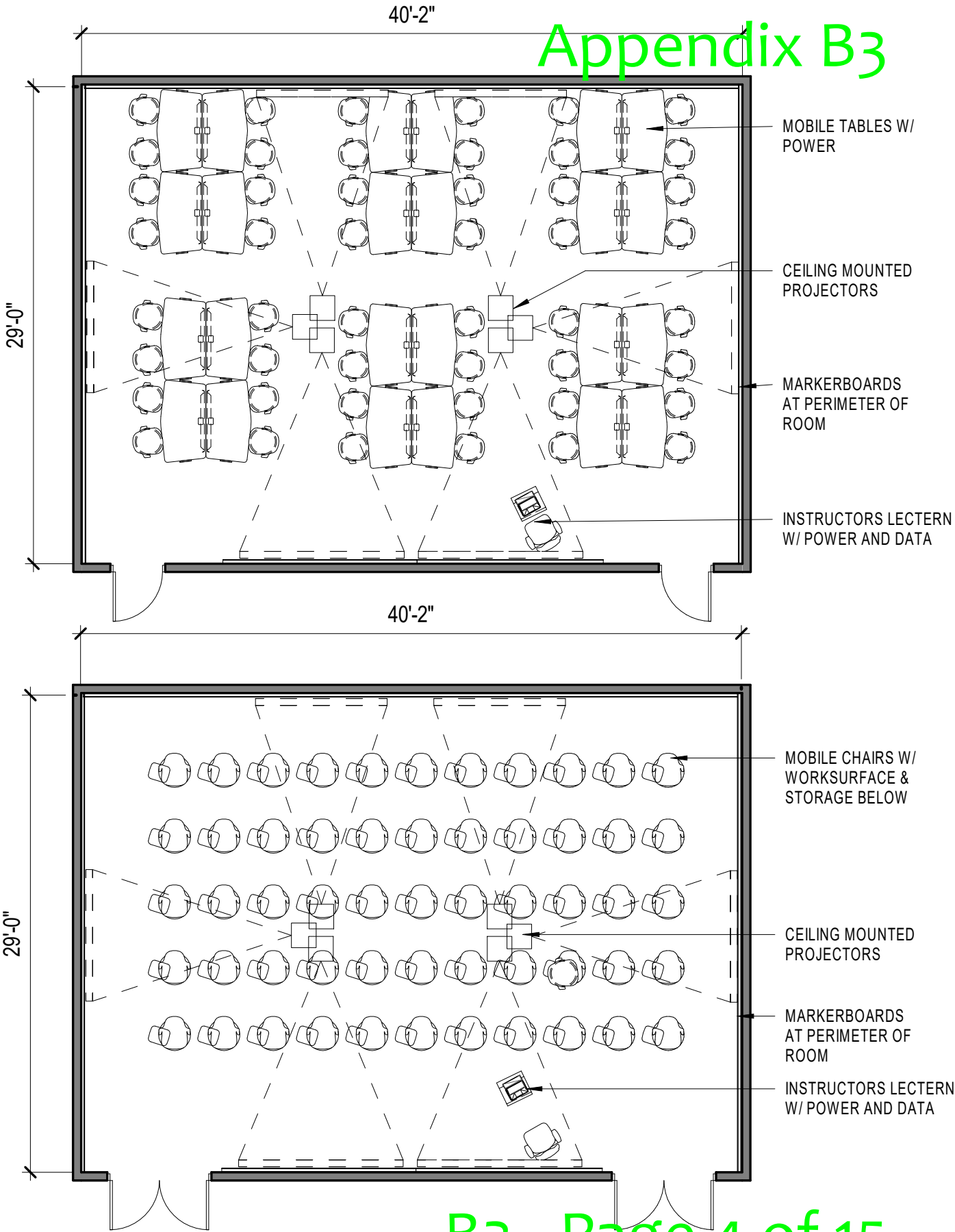

SCALE: 1/8" = 1'-0"

Room Data Sheet

GENERAL CLASSROOM - 32 STUDENTS

Department: GENERAL

Area /Occupancy		Fire Protection	Electrical
Target Area :	1,000 SF	FP System: Yes	Power: Standard
Actual Area :	1,034 SF	FP Detection: Yes	Features:
Occupants :	32		Elec. Outlets: Perimeter, Floor
Quantity :	1		Fixtures: LED
Architectural		Plumbing	Fixt. Mounting: Pendant
Floor:	Carpet Tile	Sinks: No	Occ. Sensors: Yes
Base:	Rubber	Pure Water: No	Dim Switch: Yes
Walls:	Existing CMU / Gypsum	Hot/Cold Water: NA	Task Light: No
Wall Finish:	Paint, low V.O.C.	Floor Drain: No	Emerg. Power: Yes
Ceiling:	OTS	Waste: NA	UPS: Yes
Ceiling Height:		Emer. Eyewash: No	
Door Size:	36", single leaf	Emer. Station: No	
Casework		Gases:	Communications
Wall Cabinets:	NA	Comp. Air: No	# Phone Outlets: No
Base Cabinets:	NA	Lab Gas: No	# Data Outlets: (1) Floor, (3) Wall
Counter Tops:	NA	Vacuum: No	Network: Wireless
Counter Height:	NA	CO²:	Clocks: No
Shelving:	NA	Nitrogen:	Paging System: No
Drawer Units:	NA	Oxygen:	Monitor/Alarm: No
		Other Gas:	Other:
Furnishings		HVAC	Special Requirements
Window Treat:	Light Filtering	Air Changes: Min (Occ/Unocc):Vent/0	Lighting Controls:
Proj. Screen:	Yes	Air Circulation:	Visual Controls:
Desks:	No	Pressure:	Acoustic Req:
Chairs:	Mobile	Temperature: (Clg/Htg):73F/72F	STC Rating:
Tables:	Moble		Structural Req:
Files:	No	Rel. Humidity: (Sum/Win): 55%/35%	Security:
White Boards:	Sliding	Local Exhaust:	Shielding: No
Tack Boards:	No	Air Filtration:	Other Spec Req:
Other Furn:	Instructor's Lectern	O2 Sensor:	
		Other HVAC:	
Notes			

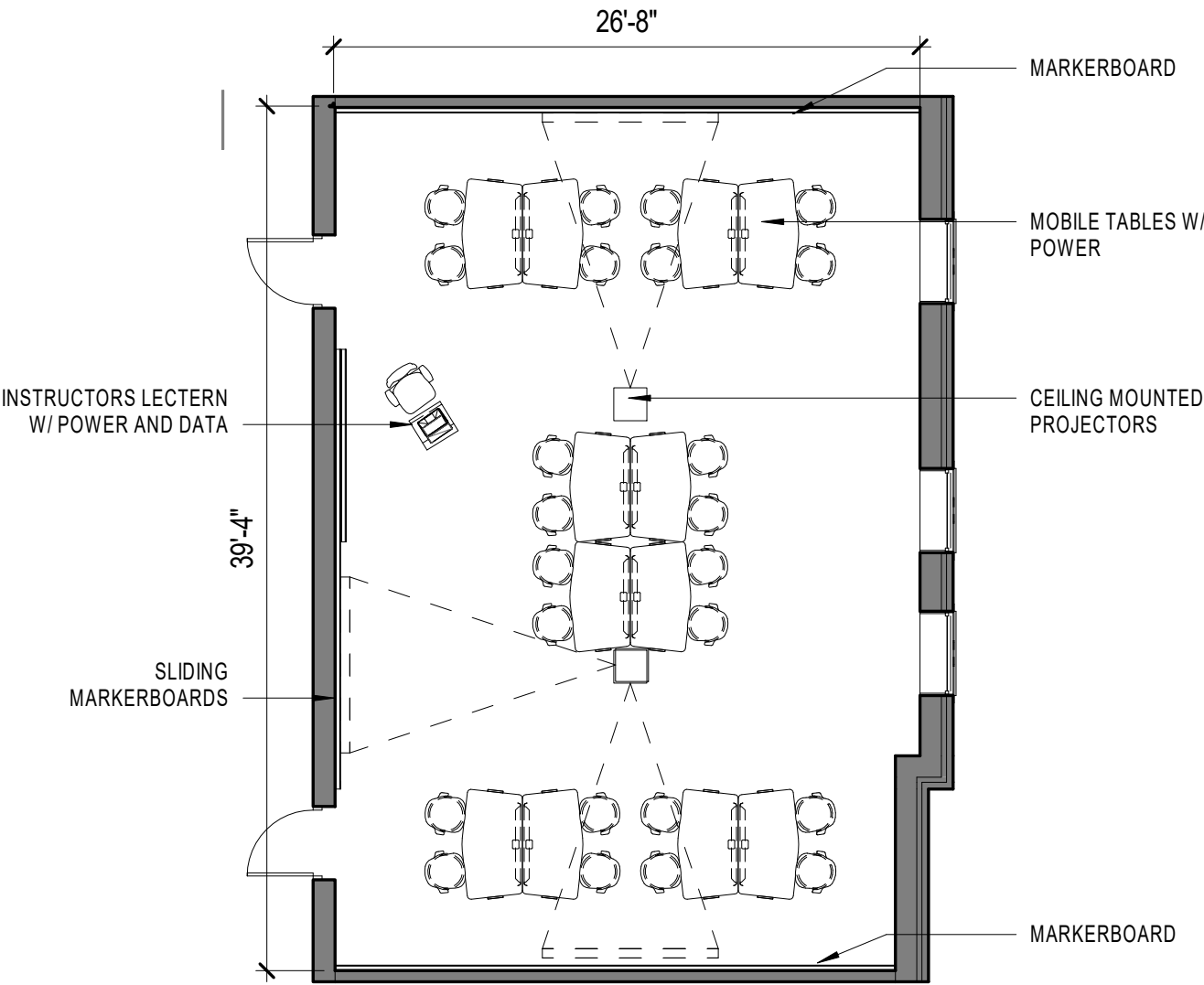

Room Data Sheet

GENERAL CLASSROOM - 24 STUDENT

Department: GENERAL

Area /Occupancy		Fire Protection	Electrical
Target Area :	750 SF	FP System: Yes	Power: Standard
Actual Area :	735 SF	FP Detection: Yes	Features:
Occupants :	24		Elec. Outlets: Perimeter , Floor
Quantity :	2		Fixtures: LED
			Fixt. Mounting: Pendant
			Occ. Sensors: Yes
			Dim Switch: Yes
Architectural		Plumbing	Task Light: No
Floor:	Carpet Tile	Sinks: No	Emerg. Power: Yes
Base:	Rubber	Pure Water: NA	UPS: Yes
Walls:	Existing CMU / Gypsum	Hot/Cold Water: NA	
Wall Finish:	Paint, V.O.C.	Floor Drain: No	
Ceiling:	OTS	Waste: NA	
Ceiling Height:		Emer. Eyewash: No	
Door Size:	36" , single leaf	Emer. Station: No	
		Gases:	
		Comp. Air: No	
		Lab Gas: No	
		Vacuum: No	
		CO ² :	
		Nitrogen:	
		Oxygen:	
		Other Gas:	
Casework			Communications
Wall Cabinets:	NA		# Phone Outlets: No
Base Cabinets:	NA		# Data Outlets: (1) Floor, (3) Wall
Counter Tops:	NA		Network: Wireless
Counter Height:	NA		Clocks: No
Shelving:	NA		Paging System: No
Drawer Units:	NA		Monitor/Alarm: No
			Other:
Furnishings		HVAC	Special Requirements
Window Treat:	Room Darkening	Air Changes: Min (Occ/Unocc):Vent/0	Lighting Controls:
Proj. Screen:	Yes	Air Circulation:	Visual Controls:
Desks:	No	Pressure:	Acoustic Req:
Chairs:	Mobile	Temperature: (Clg/Htg):73F/72F	STC Rating:
Tables:	Mobile		Structural Req:
Files:	No		Security:
White Boards:	Yes, perimeter	Rel. Humidity: (Sum/Win): 55%/35%	Shielding: No
Tack Boards:	No	Local Exhaust:	Other Spec Req:
Other Furn:	Instructor's Lectern	Air Filtration:	
		O2 Sensor:	
		Other HVAC:	
Notes			
Room darkening shades for use of projection screen at exterior wall			

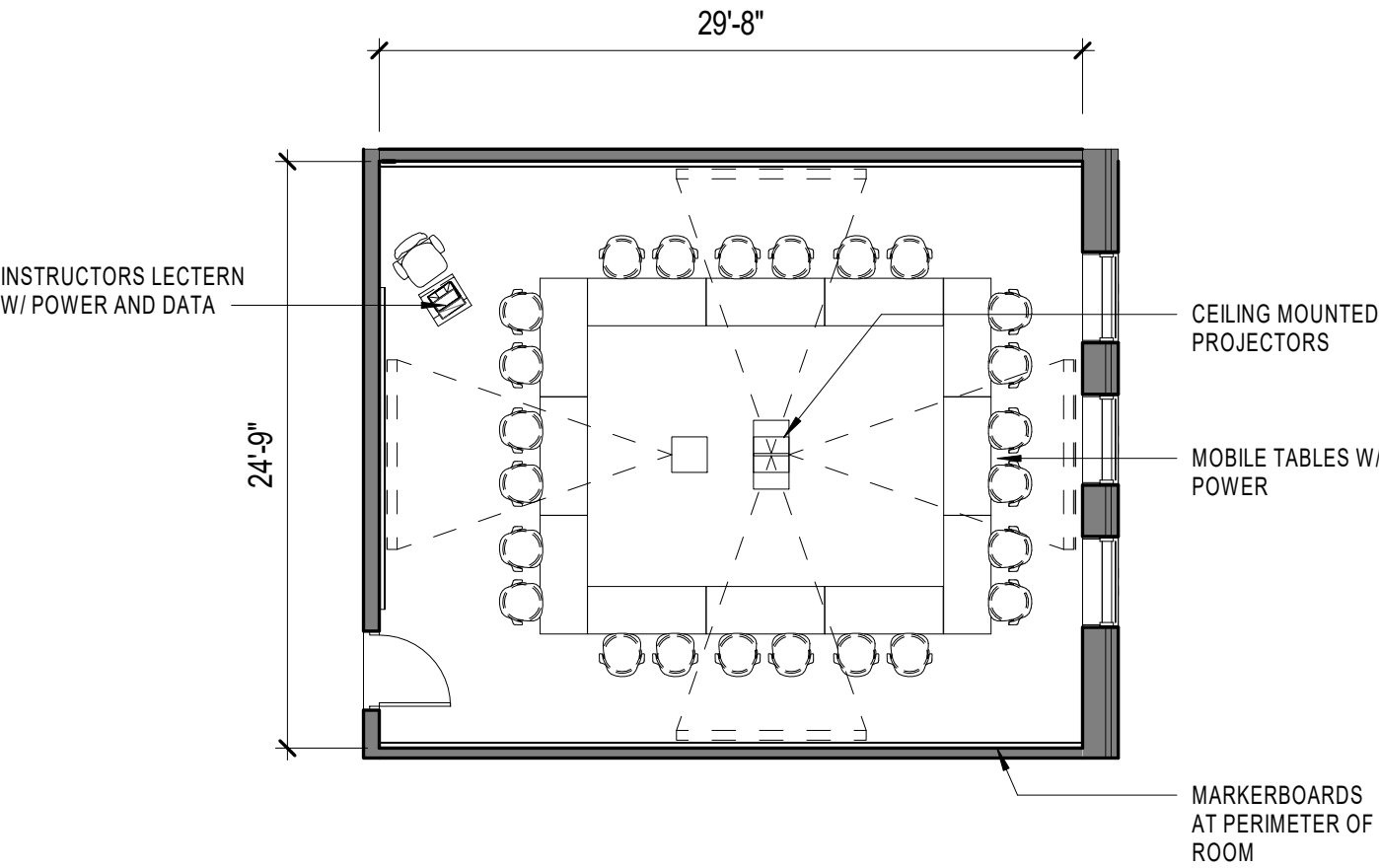

Room Data Sheet

BIOLOGY LAB - 12 STUDENT

Department: BIOLOGY

Area /Occupancy		Fire Protection		Electrical	
Target Area :	660 SF	FP System:	Yes	Power:	Standard
Actual Area :	682 SF	FP Detection:	Yes	Features:	None
Occupants :	12			Elec. Outlets:	Perimeter, Floor
Quantity :	4			Fixtures:	LED
Architectural		Plumbing		Electrical	
Floor:	Linoleum	Sinks:	Phenolic Resin	Fixt. Mounting:	Pendant
Base:	Rubber	Pure Water:	Yes	Occ. Sensors:	Yes
Walls:	Existing CMU / Gypsum	Hot/Cold Water:	Yes	Dim Switch:	Yes
Wall Finish:	Paint - low V.O.C.	Floor Drain:	At emergency Shower		
Ceiling:	OTS	Waste:	Yes	Task Light:	No
Ceiling Height:		Emer. Eyewash:	Yes	Emerg. Power:	Yes
Door Size:	3'-6" single leaf	Emer. Station:	Yes	UPS:	Yes
Casework		Plumbing		Communications	
Wall Cabinets:	Wood	Gases:		# Phone Outlets:	No
Base Cabinets:	Wood	Comp. Air:	No	# Data Outlets:	(1) Floor, (3) Wall
Counter Tops:	Phenolic Resin	Lab Gas:	No	Network:	Wireless
Counter Height:	Varies: 34" / 36"	Vacuum:	No	Clocks:	No
Shelving:	Yes, as noted	CO²:		Paging System:	No
Drawer Units:	Yes, as noted	Nitrogen:		Monitor/Alarm:	No
		Oxygen:		Other:	
		Other Gas:			
Furnishings		HVAC		Special Requirements	
Window Treat:	Light filtering	Air Changes:	Min (Occ/Unocc)6/4	Lighting Controls:	
Proj. Screen:	Yes	Air Circulation:		Visual Controls:	
Desks:	No	Pressure:	(Clg/Htg):73F/72F	Acoustic Req:	
Chairs:	Adj. height, mobile	Temperature:		STC Rating:	
Tables:	36" H, mobile			Structural Req:	
Files:	No	Rel. Humidity:	(Sum/Win): 55%/35%	Security:	Card Access
White Boards:	Sliding	Local Exhaust:		Shielding:	No
Tack Boards:	No	Air Filtration:		Other Spec Req:	
Other Furn:	Instructors Bench	O2 Sensor:			
		Other HVAC:			
Notes					

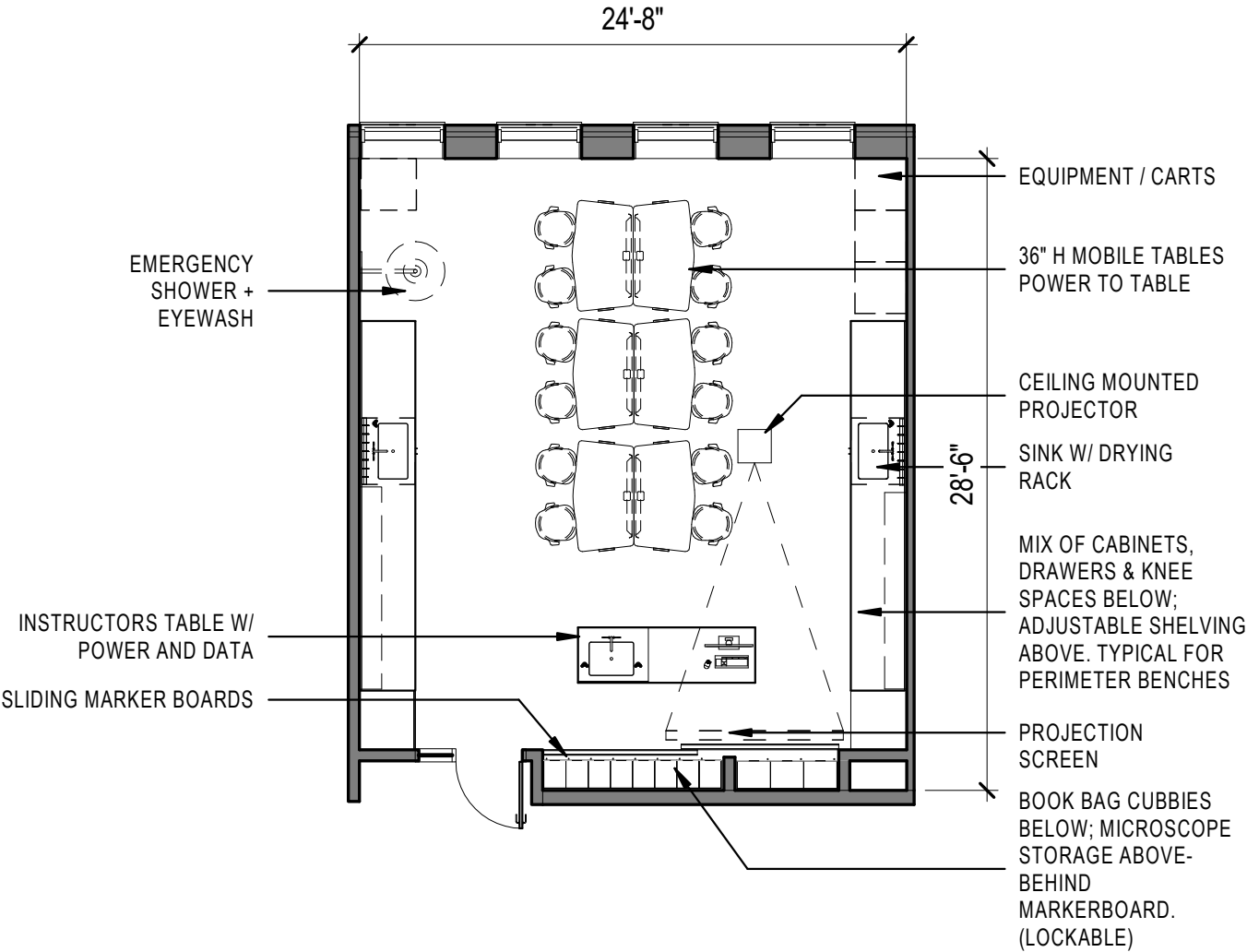

Room Data Sheet

BIOLOGY LAB - 24 STUDENT

Department: BIOLOGY

Area /Occupancy		Fire Protection		Electrical	
Target Area :	1,300 SF	FP System:	Yes	Power:	Standard
Actual Area :	1,239 SF	FP Detection:	Yes	Features:	None
Occupants :	24			Elec. Outlets:	Perimeter, Floor
Quantity :	6			Fixtures:	LED
Architectural		Plumbing		Fixt. Mounting:	Pendant
Floor:	Linoleum	Sinks:	Phenolic Resin	Occ. Sensors:	Yes
Base:	Rubber	Pure Water:	Yes	Dim Switch:	Yes
Walls:	Existing CMU / Gypsum	Hot/Cold Water:	Yes	Task Light:	No
Wall Finish:	Paint - low V.O.C.	Floor Drain:	At emergency Shower	Emerg. Power:	Yes
Ceiling:	OTS	Waste:	Yes	UPS:	Yes
Ceiling Height:		Emer. Eyewash:	Yes		
Door Size:	3'-6" single leaf	Emer. Station:	Yes		
Casework		Gases:		Communications	
Wall Cabinets:	Wood	Comp. Air:	No	# Phone Outlets:	No
Base Cabinets:	Wood	Lab Gas:	No	# Data Outlets:	(1) Floor, (3) Wall
Counter Tops:	Phenolic Resin	Vacuum:	No	Network:	Wireless
Counter Height:	Varies: 34" / 36"	CO ² :		Clocks:	No
Shelving:	Yes, as noted	Nitrogen:		Paging System:	No
Drawer Units:	Yes, as noted	Oxygen:		Monitor/Alarm:	No
		Other Gas:		Other:	
Furnishings		HVAC		Special Requirements	
Window Treat:	Light filtering	Air Changes:	Min (Occ/Unocc)6/4	Lighting Controls:	
Proj. Screen:	Yes	Air Circulation:		Visual Controls:	
Desks:	No	Pressure:		Acoustic Req:	
Chairs:	Adj. height, mobile	Temperature:	(Clg/Htg):73F/72F	STC Rating:	
Tables:	36" H, mobile			Structural Req:	
Files:	No	Rel. Humidity:	(Sum/Win): 55%/35%	Security:	Card Access
White Boards:	Sliding	Local Exhaust:		Shielding:	No
Tack Boards:	No	Air Filtration:		Other Spec Req:	
Other Furn:	Instructors Bench	O2 Sensor:			
		Other HVAC:			
Notes					

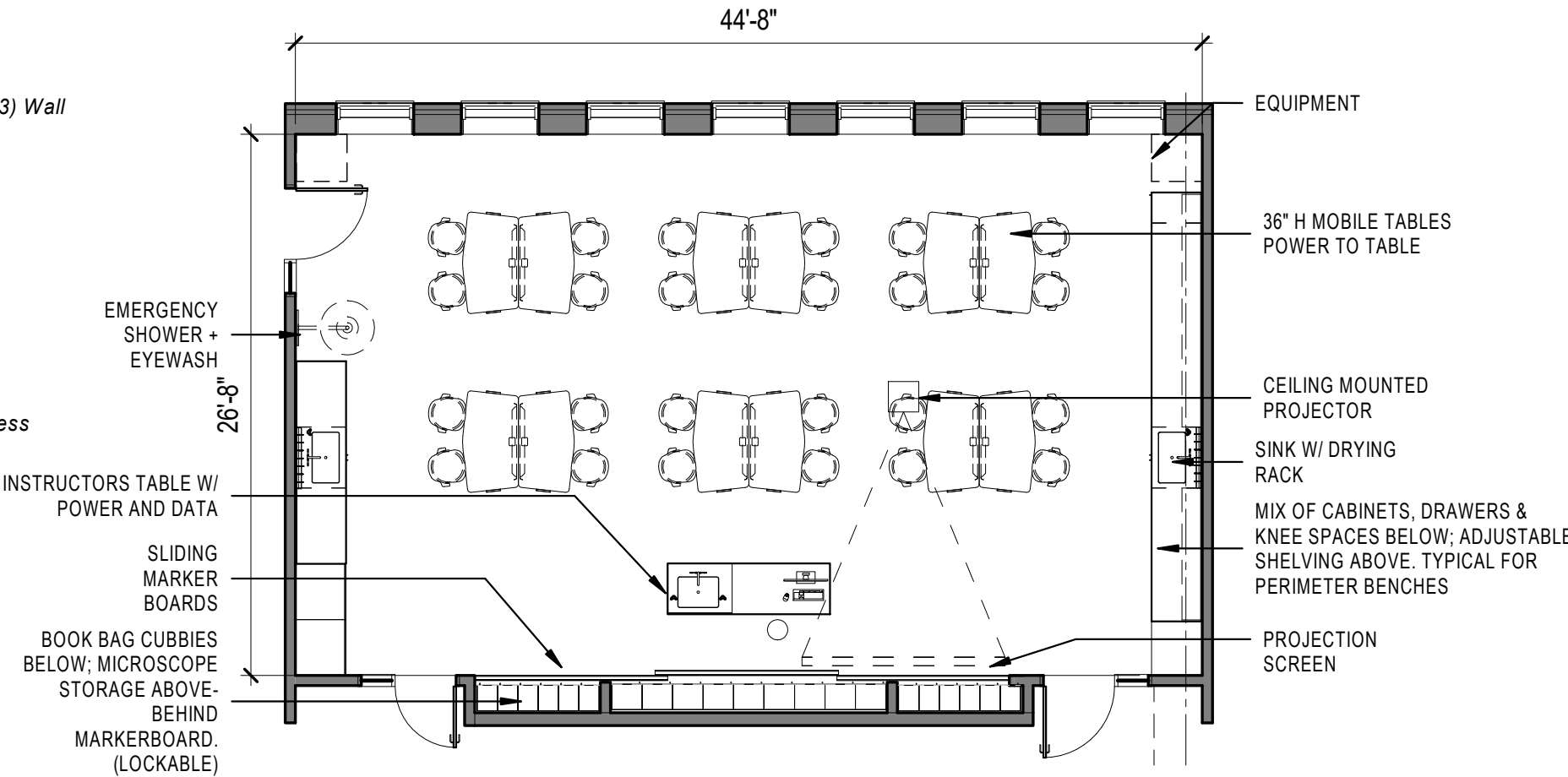

Appendix B3

Department: BIOLOGY

Area /Occupancy

Target Area : 1,600 SF
Actual Area : 1,551 SF
Occupants : 32
Quantity : 1

Fire Protection

FP System: Yes
FP Detection: Yes

Electrical

Power:	<i>Standard</i>
Features:	<i>None</i>
Elec. Outlets:	<i>Perimeter, Floor</i>
Fixtures:	<i>LED</i>
Fixt. Mounting:	<i>Pendant</i>
Occ. Sensors:	<i>Yes</i>
Dim Switch:	<i>Yes</i>

Task Light: No
Emerg. Power: Yes
UPS: Yes

Communications

Phone Outlets: *No*
Data Outlets: *(1) Floor, (3) Wall*
Network: *Wireless*
Clocks: *No*
Paging System: *No*
Monitor/Alarm: *No*
Other:

Special Requirements

Lighting Controls:
Visual Controls:
Acoustic Req:
STC Rating:
Structural Req:
Security: *Card Access*
Shielding: *No*
Other Spec Req:

Architectural

Floor: *Linoleum*
Base: *Rubber*
Walls: *Existing CMU / Gypsum*
Wall Finish: *Paint - low V.O.C.*
Ceiling: *OTS*
Ceiling Height:
Door Size: *3'-6" single leaf*

Plumbing

Sinks: *Phenolic Resin*
 Pure Water: Yes
 Hot/Cold Water: Yes
 Floor Drain: *At emergency Shower*
 Waste: Yes
 Emer. Eyewash: Yes
 Emer. Station: Yes
 Gases:

Casework

Wall Cabinets: *Wood*
Base Cabinets: *Wood*
Counter Tops: *Phenolic Resin*
Counter Height: *Varies: 34" / 36"*
Shelving: *Yes, as noted*
Drawer Units: *Yes, as noted*

Comp. Air:

Lab Gas: No
Vacuum: No
CO₂:
Nitrogen:
Oxygen:
Other Gas:

Furnishings

Window Treat: *Light filtering*
 Proj. Screen: *Yes*
 Desks: *No*
 Chairs: *Adj. height, mobile*
 Tables: *36" H, mobile*
 Files: *No*
 White Boards: *Sliding*
 Tack Boards: *No*
 Other Furn: *Instructors Bench*

HVAC

Air Changes: *Min (Occ/Unocc)6/4*
 Air Circulation:
 Pressure:
 Temperature: *(Clg/Htg):73F/72F*
 Rel. Humidity: *(Sum/Win): 55%/35%*
 Local Exhaust:
 Air Filtration:
 O2 Sensor:
 Other HVAC:

Notes

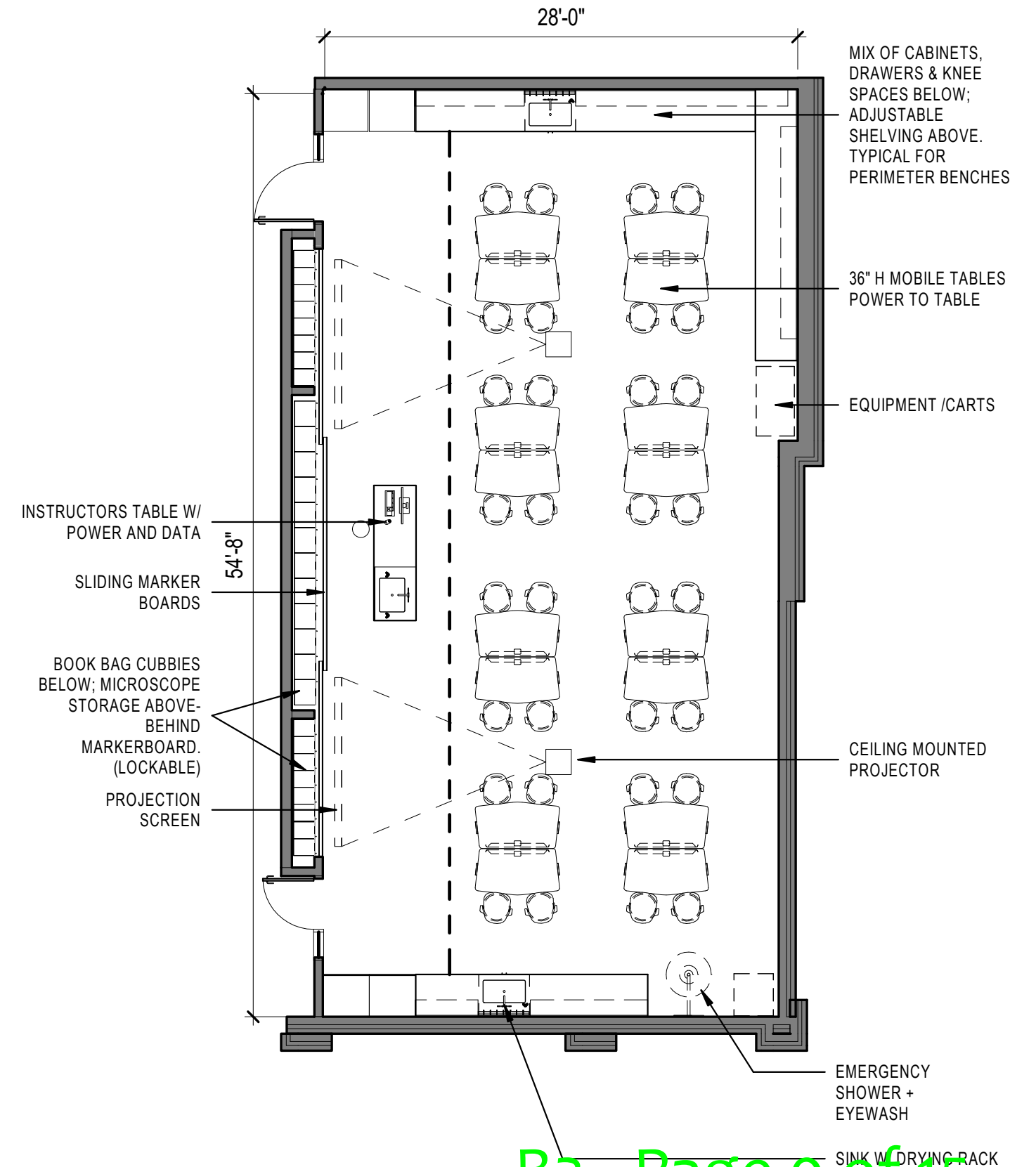

B3 - Page 9 of 15

SCALE: 1/8" = 1'-0"

CLARK NEXSEN

Room Data Sheet

BIOLOGY PREP / STORAGE ROOM

Department: Biology

Area /Occupancy		Fire Protection	Electrical
Target Area :	600	FP System: Yes	Power: Standard
Actual Area :	637 SF	FP Detection: Yes	Features:
Occupants :			Elec. Outlets: Perimeter, ceiling reel
Quantity :	6		Fixtures: LED
Architectural		Plumbing	Fixt. Mounting: Pendant
Floor:	Linoleum	Sinks: Phenolic Resin	Occ. Sensors: Yes
Base:	Rubber	Pure Water: Yes	Dim Switch: Yes
Walls:	Existing CMU / Gypsum	Hot/Cold Water: Yes	Task Light: No
Wall Finish:	Paint - low v.o.c.	Floor Drain: At eyewash	Emerg. Power: Yes
Ceiling:	OTS	Waste: Yes	UPS: Yes
Ceiling Height:		Emer. Eyewash: Yes	
Door Size:	3'-6" single leaf	Emer. Station: Yes	
Casework		Gases:	Communications
Wall Cabinets:	Wood	Comp. Air: Yes	# Phone Outlets: No
Base Cabinets:	Wood	Lab Gas: Yes	# Data Outlets: 4
Counter Tops:	Phenolic Resin	Vacuum: Yes	Network: Wireless
Counter Height:	Varies: 34" / 36"	CO ² :	Clocks: No
Shelving:	Yes, as noted	Nitrogen:	Paging System: No
Drawer Units:	Yes, as noted	Oxygen:	Monitor/Alarm: No
		Other Gas:	Other:
Furnishings		HVAC	Special Requirements
Window Treat:	Light filtering	Air Changes: Min (Occ/Unocc)6/4	Lighting Controls:
Proj. Screen:	No	Air Circulation:	Visual Controls:
Desks:	No	Pressure:	Acoustic Req:
Chairs:	Mobile	Temperature: (Clg/Htg):73F/72F	STC Rating:
Tables:	Mobile		Structural Req:
Files:	No	Rel. Humidity: (Sum/Win): 55%/35%	Security: Card Access
White Boards:	No	Local Exhaust:	Shielding: No
Tack Boards:	No	Air Filtration:	Other Spec Req:
Other Furn:		O2 Sensor:	
		Other HVAC:	
Notes			

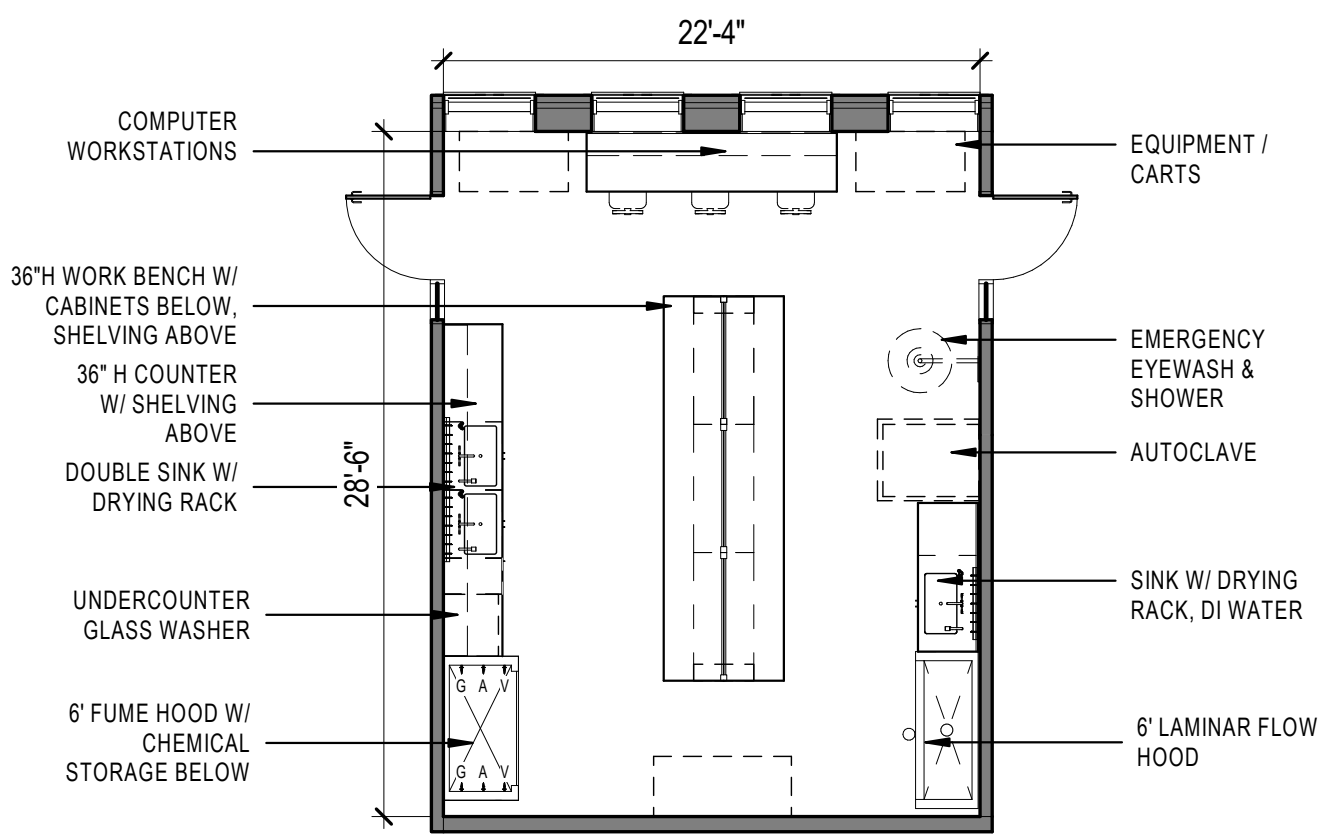

Room Data Sheet

CHEMISTRY LAB- 12 STUDENT

Department: CHEMISTRY

Appendix B3

Area /Occupancy		Fire Protection		Electrical	
Target Area :	660 SF	FP System:	Yes	Power:	Standard
Actual Area :	673 SF	FP Detection:	Yes	Features:	None
Occupants :	12			Elec. Outlets:	Perimeter, Floor
Quantity :	1			Fixtures:	LED
Architectural		Plumbing		Electrical	
Floor:	Linoleum	Sinks:	Phenolic Resin	Fixt. Mounting:	Pendant
Base:	Rubber	Pure Water:	Yes	Occ. Sensors:	Yes
Walls:	Existing CMU / Gypsum	Hot/Cold Water:	Yes	Dim Switch:	Yes
Wall Finish:	Paint - low V.O.C.	Floor Drain:	At emergency Shower	Task Light:	No
Ceiling:	OTS	Waste:	Yes	Emerg. Power:	Yes
Ceiling Height:		Emer. Eyewash:	Yes	UPS:	Yes
Door Size:	3'-6" single leaf	Emer. Station:	Yes		
Casework		Gases:		Communications	
Wall Cabinets:	Wood	Comp. Air:	Yes	# Phone Outlets:	No
Base Cabinets:	Wood	Lab Gas:	Yes	# Data Outlets:	(4) Floor, (3) Wall
Counter Tops:	Phenolic Resin	Vacuum:	Yes	Network:	Wireless
Counter Height:	Varies: 34" / 36"	CO ² :		Clocks:	No
Shelving:	Yes, as noted	Nitrogen:		Paging System:	NA
Drawer Units:	Yes, as noted	Oxygen:		Monitor/Alarm:	No
		Other Gas:		Other:	
Furnishings		HVAC		Special Requirements	
Window Treat:	Light filtering	Air Changes:	Min (Occ/Unocc)6/4	Lighting Controls:	
Proj. Screen:	Yes	Air Circulation:		Visual Controls:	
Desks:	No	Pressure:	(Clg/Htg):73F/72F	Acoustic Req:	
Chairs:	Adj. height, mobile	Temperature:		STC Rating:	
Tables:	Fixed			Structural Req:	
Files:	No	Rel. Humidity:	(Sum/Win): 55%/35%	Security:	Card Access
White Boards:	Sliding	Local Exhaust:		Shielding:	No
Tack Boards:	No	Air Filtration:		Other Spec Req:	
Other Furn:	Instructors Bench	O2 Sensor:			
		Other HVAC:			
Notes					

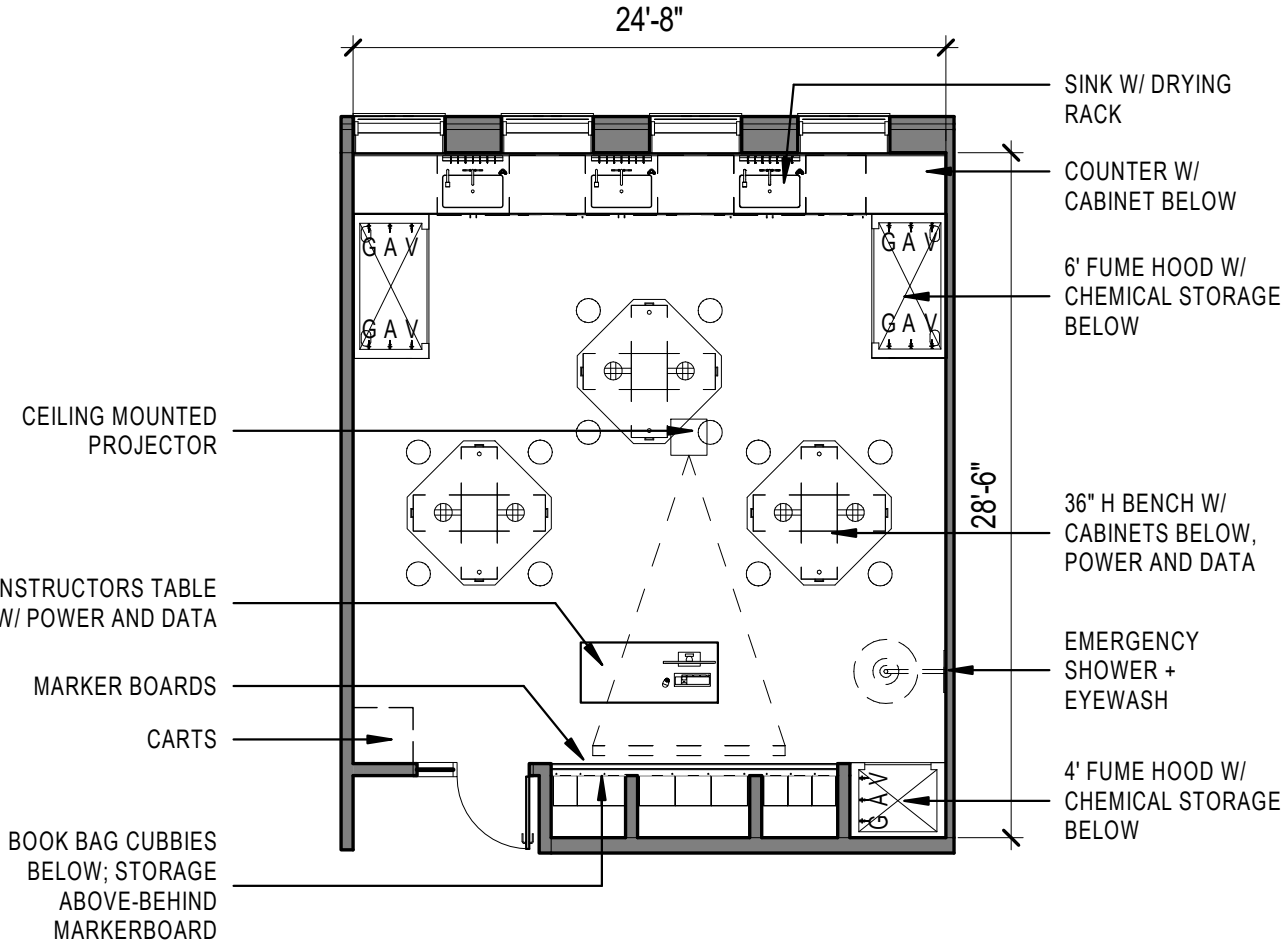

SCALE: 1/8" = 1'-0"

Room Data Sheet

CHEMISTRY LAB - 24 STUDENTS

Department: CHEMISTRY

Area /Occupancy		Fire Protection		Electrical	
Target Area :	1,300 SF	FP System:	Yes	Power:	Standard
Actual Area :	1,228 SF	FP Detection:	Yes	Features:	None
Occupants :	24			Elec. Outlets:	Perimeter, Floor
Quantity :	4			Fixtures:	LED
				Fixt. Mounting:	Pendant
				Occ. Sensors:	Yes
				Dim Switch:	Yes
				Task Light:	No
				Emerg. Power:	Yes
				UPS:	Yes
Architectural		Plumbing		Communications	
Floor:	Linoleum	Sinks:	Phenolic Resin	# Phone Outlets:	No
Base:	Rubber	Pure Water:	Yes	# Data Outlets:	(7) Floor, (4) Wall
Walls:	Existing CMU / Gypsum	Hot/Cold Water:	Yes	Network:	Wireless
Wall Finish:	Paint - low V.O.C.	Floor Drain:	At eyewash	Clocks:	No
Ceiling:	OTS	Waste:	Yes	Paging System:	No
Ceiling Height:		Emer. Eyewash:	Yes	Monitor/Alarm:	No
Door Size:	3'-6" single leaf	Emer. Station:	Yes	Other:	
		Gases:			
		Comp. Air:	Yes		
		Lab Gas:	Yes		
		Vacuum:	Yes		
		CO ² :			
		Nitrogen:			
		Oxygen:			
		Other Gas:			
Casework		HVAC		Special Requirements	
Wall Cabinets:	Wood	Air Changes:	Min (Occ/Unocc)6/4	Lighting Controls:	
Base Cabinets:	Wood	Air Circulation:		Visual Controls:	
Counter Tops:	Phenolic Resin	Pressure:	(Clg/Htg):73F/72F	Acoustic Req:	
Counter Height:	Varies: 34" / 36"	Temperature:		STC Rating:	
Shelving:	Yes, as noted	Rel. Humidity:	(Sum/Win): 55%/35%	Structural Req:	
Drawer Units:	Yes, as noted	Local Exhaust:		Security:	Card Access
		Air Filtration:		Shielding:	No
		O2 Sensor:		Other Spec Req:	
		Other HVAC:			
Furnishings					
Window Treat:	Light Filtering				
Proj. Screen:	Yes				
Desks:	No				
Chairs:	Mobile, stools				
Tables:	Fixed				
Files:	No				
White Boards:	Sliding				
Tack Boards:	No				
Other Furn:	Instructors Bench				
Notes					

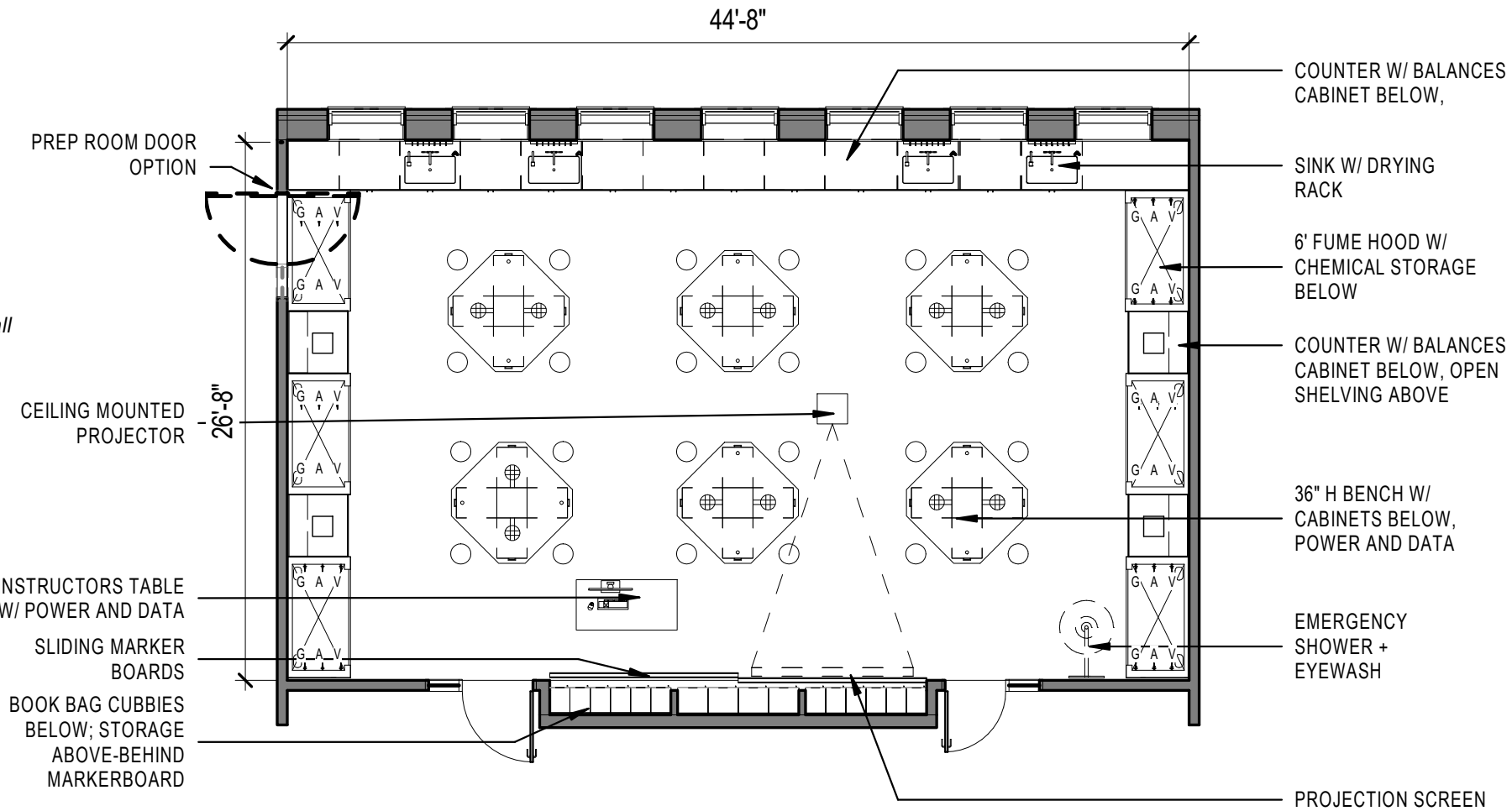

SCALE: 1/8" = 1'-0"

Room Data Sheet

CHEMISTRY LAB - 32 STUDENTS

Department: CHEMISTRY

Area /Occupancy		Fire Protection	Electrical
Target Area :	1,600 SF	FP System: Yes	Power: Standard
Actual Area :	1,574 SF	FP Detection: Yes	Features: None
Occupants :	32		Elec. Outlets: Perimeter, Floor
Quantity :	1		Fixtures: LED
Architectural		Plumbing	Fixt. Mounting: Pendant
Floor:	Linoleum	Sinks: Phenolic Resin	Occ. Sensors: Yes
Base:	Rubber	Pure Water: Yes	Dim Switch: Yes
Walls:	Existing CMU / Gypsum	Hot/Cold Water: Yes	Task Light: No
Wall Finish:	Paint - low V.O.C.	Floor Drain: At eyewash	Emerg. Power: Yes
Ceiling:	OTS	Waste: Yes	UPS: Yes
Ceiling Height:		Emer. Eyewash: Yes	
Door Size:	3'-6" single leaf	Emer. Station: Yes	
Casework		Gases:	Communications
Wall Cabinets:	Wood	Comp. Air: Yes	# Phone Outlets: No
Base Cabinets:	Wood	Lab Gas: Yes	# Data Outlets: (9)Floor, (3) Wall
Counter Tops:	Phenolic Resin	Vacuum: Yes	Network: Wireless
Counter Height:	Varies: 34" / 36"	CO²:	Clocks: No
Shelving:	Yes, as noted	Nitrogen:	Paging System: No
Drawer Units:	Yes, as noted	Oxygen:	Monitor/Alarm: No
		Other Gas:	Other:
Furnishings		HVAC	Special Requirements
Window Treat:	Light Filtering	Air Changes: Min (Occ/Unocc)6/4	Lighting Controls:
Proj. Screen:	Yes	Air Circulation:	Visual Controls:
Desks:	No	Pressure:	Acoustic Req:
Chairs:	Mobile, stools	Temperature: (Clg/Htg):73F/72F	STC Rating:
Tables:	Fixed		Structural Req:
Files:	No	Rel. Humidity: (Sum/Win): 55%/35%	Security: Card Access
White Boards:	Sliding	Local Exhaust:	Shielding: No
Tack Boards:	No	Air Filtration:	Other Spec Req:
Other Furn:	Instructors Bench	O2 Sensor:	
		Other HVAC:	
Notes			

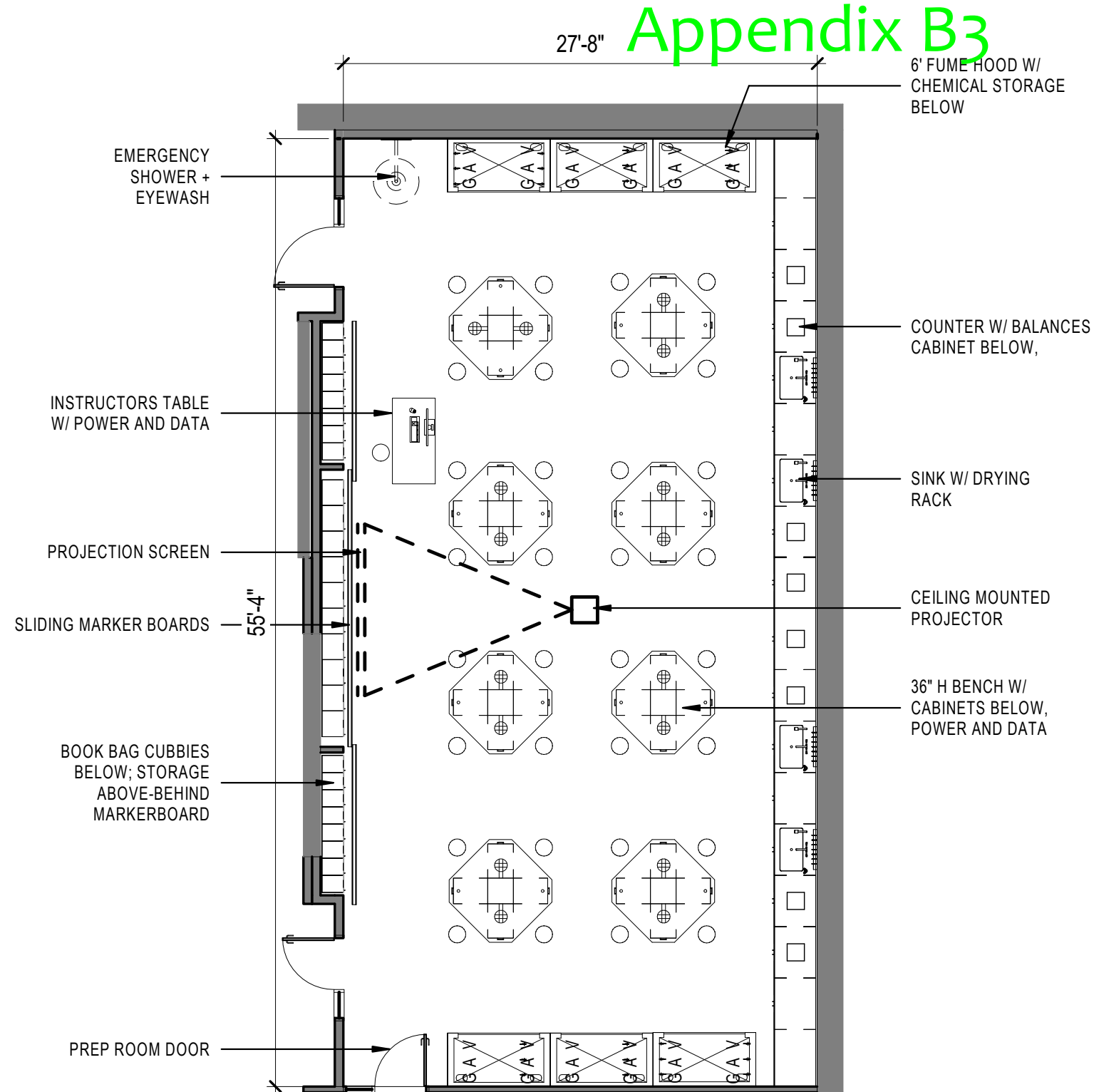

27'-8" Appendix B3

Room Data Sheet

CHEMISTRY PREP / STORAGE

Department: CHEMISTRY

Appendix B3

Area /Occupancy		Fire Protection		Electrical	
Target Area :	600	FP System:	Yes	Power:	Standard
Actual Area :	637 SF	FP Detection:	Yes	Features:	None
Occupants :				Elec. Outlets:	Perimeter, Ceiling
Quantity :	4			Fixtures:	LED
Architectural		Plumbing		Communications	
Floor:	Linoleum	Sinks:	Phenolic Resin	Task Light:	No
Base:	Rubber	Pure Water:	Yes	Emerg. Power:	Yes
Walls:	Existing CMU / Gypsum	Hot/Cold Water:	Yes	UPS:	Yes
Wall Finish:	Paint - low v.o.c.	Floor Drain:	Yes		
Ceiling:	OTS	Waste:	Yes		
Ceiling Height:		Emer. Eyewash:	Yes		
Door Size:	3'-6" single leaf	Emer. Station:	Yes		
Casework		Gases:			
Wall Cabinets:	Wood	Comp. Air:	Yes	# Phone Outlets:	No
Base Cabinets:	Wood	Lab Gas:	Yes	# Data Outlets:	4
Counter Tops:	Phenolic Resin	Vacuum:	Yes	Network:	Wireless
Counter Height:	Varies: 34" / 36"	CO ² :		Clocks:	No
Shelving:	Yes, as noted	Nitrogen:		Paging System:	No
Drawer Units:	Yes, as noted	Oxygen:		Monitor/Alarm:	No
		Other Gas:		Other:	
Furnishings		HVAC		Special Requirements	
Window Treat:	Light filtering	Air Changes:	Min (Occ/Unocc)6/4	Lighting Controls:	
Proj. Screen:	No	Air Circulation:		Visual Controls:	
Desks:	No	Pressure:	(Clg/Htg):73F/72F	Acoustic Req:	
Chairs:	Mobile	Temperature:		STC Rating:	
Tables:	Mobile			Structural Req:	
Files:	No	Rel. Humidity:	(Sum/Win): 55%/35%	Security:	Card Access
White Boards:	Yes	Local Exhaust:		Shielding:	No
Tack Boards:	Yes	Air Filtration:		Other Spec Req:	
Other Furn:		O2 Sensor:			
		Other HVAC:			
Notes					

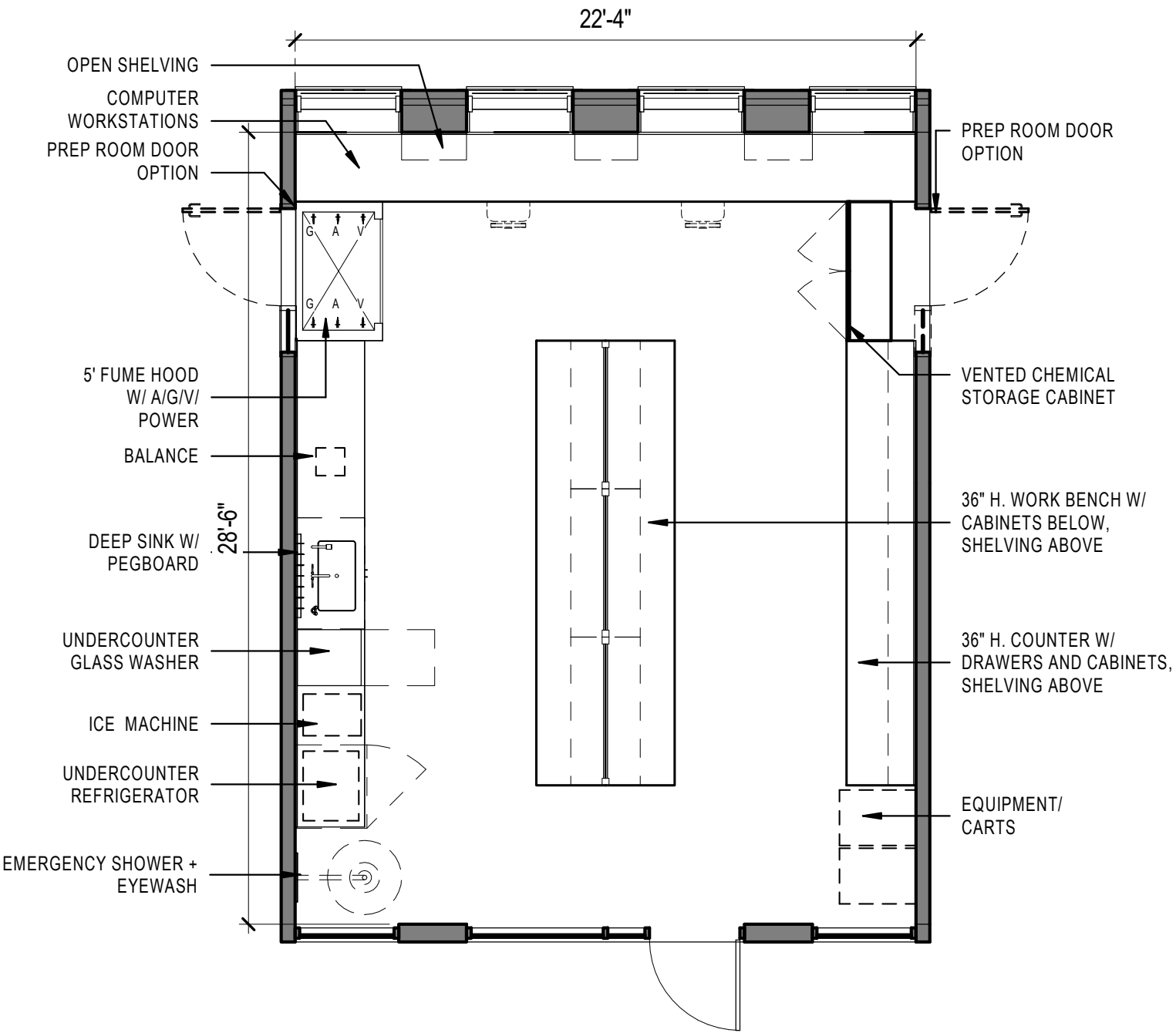

SCALE: 1/8" = 1'-0"



Room Data Sheet

RESEARCH LAB

Department: Interdisciplinary - Chemistry, Biology, Physics

Area /Occupancy

Target Area : 900
Actual Area : 1,024 SF
Occupants : 2
Quantity : 27

Fire Protection

FP System: Yes
FP Detection: Yes

Electrical

Power: Standard
Features: None
Elec. Outlets: Perimeter, Ceiling
Fixtures: LED
Fixt. Mounting: Pendant
Occ. Sensors: Yes
Dim Switch: Yes

Architectural

Floor: Linoleum
Base: Rubber
Walls: Existing CMU / Gypsum
Wall Finish: Paint - low v.o.c
Ceiling: OTS
Ceiling Height:
Door Size: 3'-6" single leaf

Plumbing

Sinks: Phenolic Resin
Pure Water: Yes
Hot/Cold Water: Yes
Floor Drain: At eyewash
Waste: Yes
Emer. Eyewash: Yes
Emer. Station: Yes
Gases:

Casework

Wall Cabinets: Wood
Base Cabinets: Wood
Counter Tops: Phenolic Resin
Counter Height: Varies: 34" / 36"
Shelving: Yes, as noted
Drawer Units: Yes, as noted

Comp. Air: Yes
Lab Gas: Yes
Vacuum: Yes

CO²:
Nitrogen:
Oxygen:
Other Gas:

Communications

Phone Outlets: No
Data Outlets: 4
Network: Wireless
Clocks: No
Paging System: No
Monitor/Alarm: No
Other:

Furnishings

Window Treat: Light filtering
Proj. Screen: No
Desks: No
Chairs: Mobile
Tables: Mobile
Files: No
White Boards: Yes
Tack Boards: No
Other Furn:

HVAC

Air Changes: Min (Occ/Unocc)6/4
Air Circulation:
Pressure:
Temperature: (Clg/Htg):73F/72F

Rel. Humidity: (Sum/Win): 55%/35%
Local Exhaust:
Air Filtration:
O2 Sensor:
Other HVAC:

Special Requirements

Lighting Controls:
Visual Controls:
Acoustic Req:
STC Rating:
Structural Req:
Security: Card Access
Shielding: No
Other Spec Req:

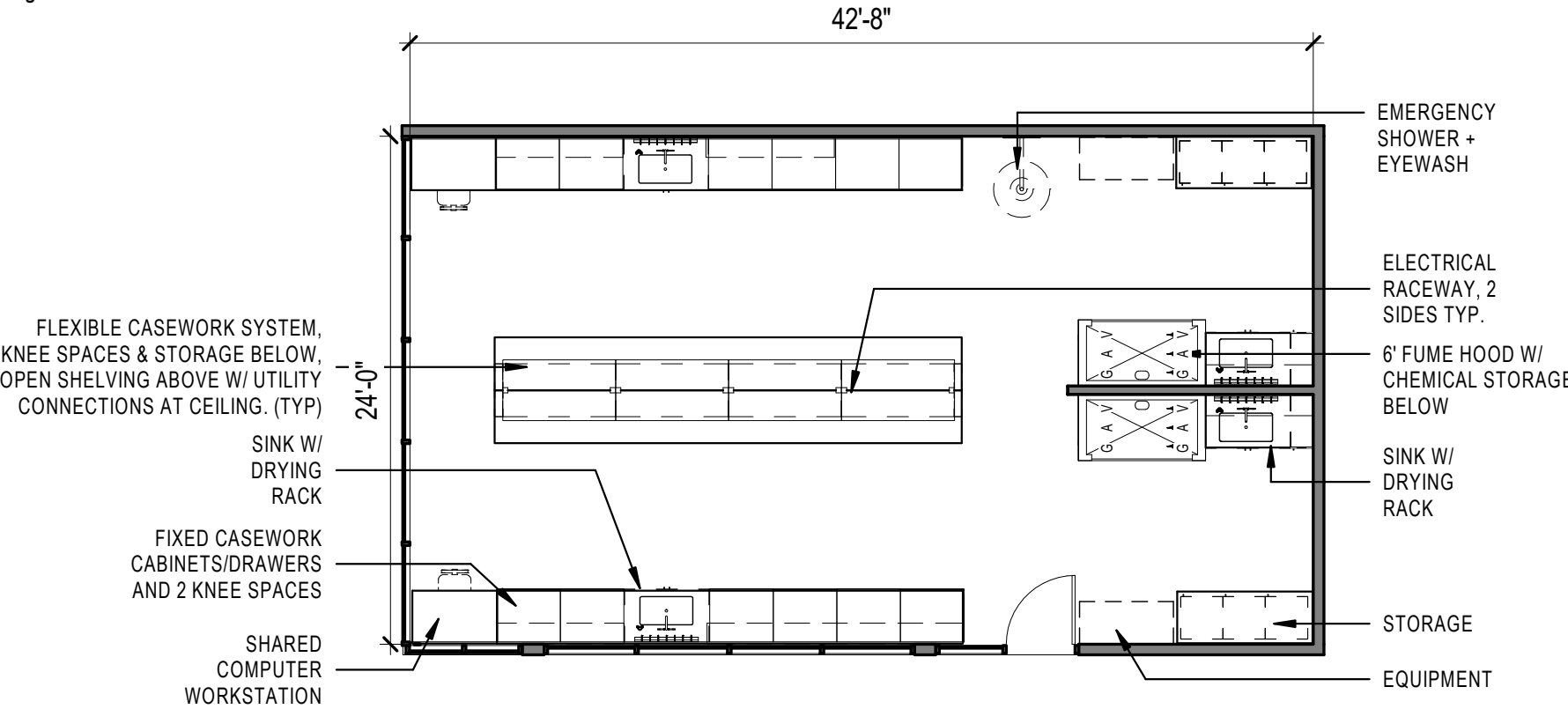

Notes

SCALE: 1/8" = 1'-0"

